



Specification

Crystal Filter 10MHz

P/N: 10M01B50

Item	Typical
Central Frequency (Fc, MHz)	10
Insertion Loss (dB)	3.5
Bandwidth with -3.0dB (kHz)	1.0
Ripple Within Pass Band (dB)	1.0
Bandwidth at -40 dB Attenuation (kHz)	3.5
Ultimate Rejection (dB)	≥50
I/O Impedance (Ω)	50
I/O VSWR	≤1.8
Operation Temperature (°C)	-20 ~ +70
Storage Temperature (°C)	-40 ~ +80
Package Size (mm)	25x15x11

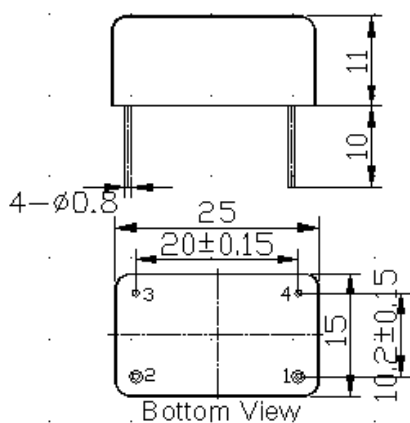

Pin No.	Description
1	Input/Output
2	Output/Input
3,4	Ground